

The Mouldfit range of "Blind Inserts" is suitable for compression and injection processes. This range is installed directly into the mould tool, providing a high performance fixing.

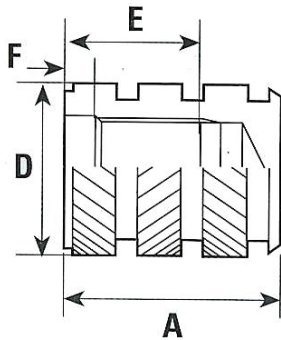

P/NO	PRODUCT CODE	THREAD	A	D	E	F
00301	F6/T1	M3	7.3	4.7	4.6	1.3
00306	F6/T1	M4	10.2	6.3	6.7	1.8
00286	F6/T1	M5	11.2	7.3	7.4	2.0
00307	F6/T1	M6	14.4	9.8	8.1	2.0
00313	F6/T1	M8	16.5	11.4	11.1	2.3

LOCATION PINS

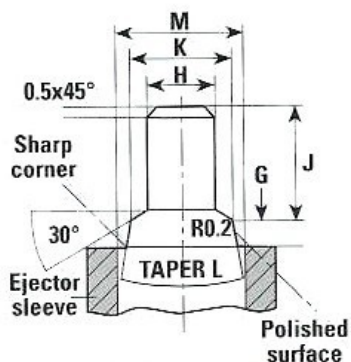

Threaded Size	G	H	J	K	L	M
<i>ISO Metrics</i>	<i>mm</i>	<i>mm</i>	<i>mm</i>	<i>mm</i>	<i>degrees</i>	<i>mm</i>
2	0.80	1.55	2.65	2.300	6.0	3.0
2.5	0.90	2.00	3.00	2.800	5.0	3.5
3	1.05	2.45	3.40	3.125	4.5	4.0
3.5	1.30	2.85	4.55	3.750	4.5	4.7
5	1.55	3.25	5.00	4.425	4.5	5.4
5	1.70	4.15	5.55	5.125	5.0	6.0
6	1.80	4.95	6.15	6.600	5.5	8.0
8	2.00	6.70	9.00	8.500	6.0	10.0
10	2.10	8.40	9.70	10.500	6.0	12.0

Fitsco Industries Ltd, Unit B, Middleblock,
Knowle Sands Industrial Estate, Eardington, Bridgnorth,
Shropshire WV16 5JL,